

Hunters Court, Abington



Directions

From the Roundabout at The Motorway Service Station, follow the road into Abington. The development is on the right hand side past the Hotel.

Access and parking is from the courtyard.

Photograph

Not yet available

Description

External walls comprise white insulated roughcast with red cast stone details. Fascias are of prefinished board. The roof is constructed of timber trusses, ply sarking and grey slate effect roof tiles.

Block Plan

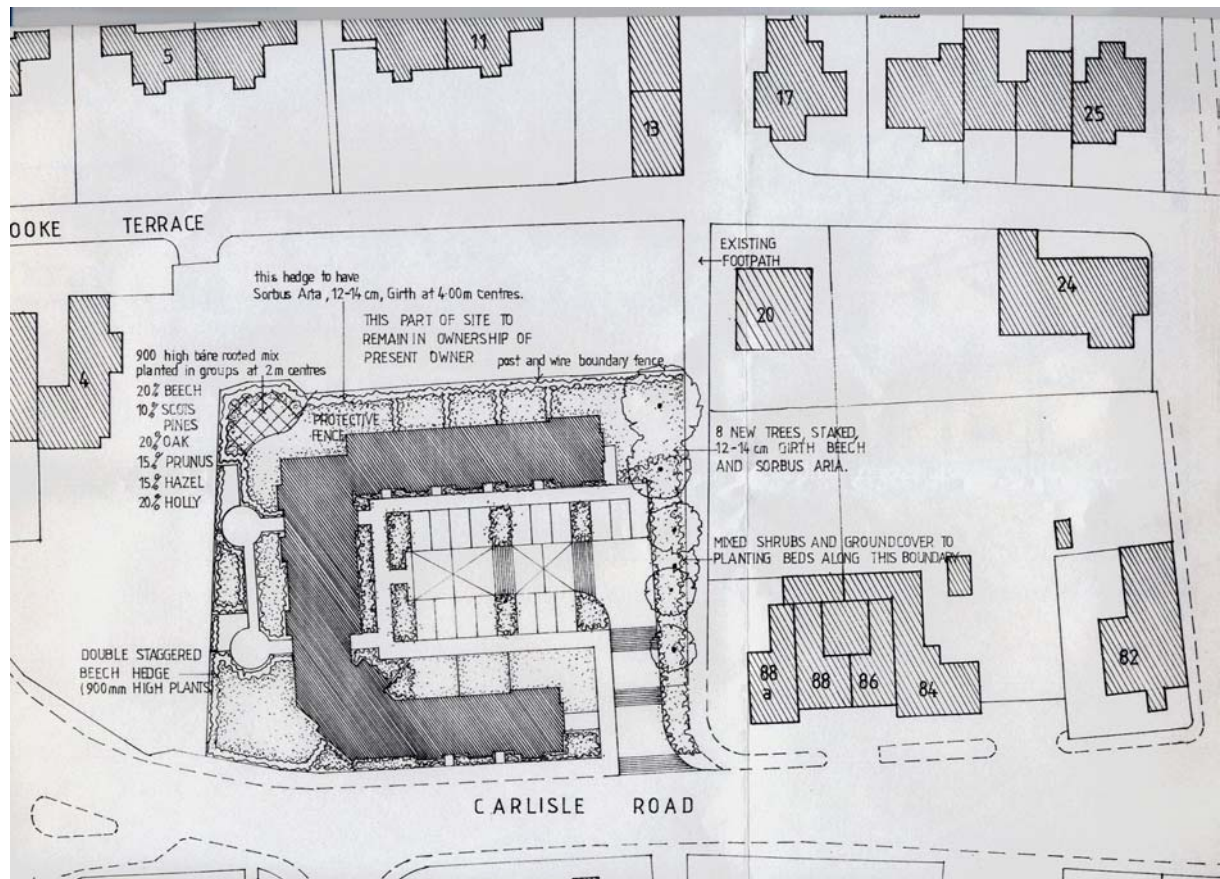

Accommodation

The accommodation is located in a three-sided courtyard. Numbers run clockwise from the left from 1 – 18.

- ❖ Numbers 1-3 are houses.
- ❖ Numbers 4 – 13 are flats off corner closes.
- ❖ Numbers 14 – 18 are houses.
- ❖ All property is two storey.

Major components

Heating	Comfortplus electric central heating. Dimplex off peak storage radiators in livingroom kitchen & hallway. Dimplex Panel convectors in bedrooms. Dimplex wall mounted fan heater in bathroom.
Hot water	T&D Trident 210 litre direct unvented tanks with 2Nr 3kW Redring off peak Immersion heaters.
Switchgear	Separate MK consumer units for domestic and heating. Off peak & domestic meters with Scottish Power teleswitch. Switches and sockets generally to "MK" standard.
Smoke detectors	One in flats, two per house. AICO E160 series optical detectors. 10 year rechargeable lithium non-removeable battery. Replaced in 2001.
Windows	3 point locking tilt & turn softwood windows. Single handle. All double glazed. Escape windows in bedrooms.
External Doors	<u>Houses</u> – Swedish doosets with double glazed panels. <u>Flats</u> – Solid core ply faced 44mm thick doors from blanks.
Kitchens	Manufactured by JTC of Dundee.